

Mary McClure

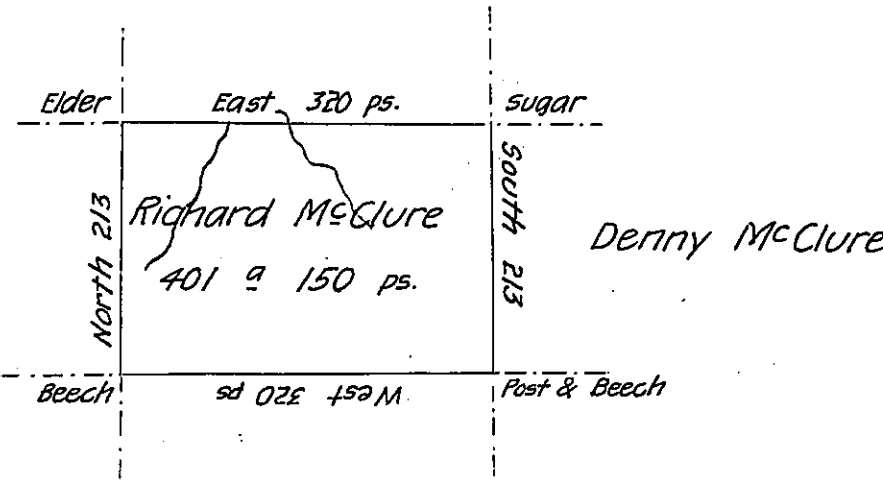

Samuel Hodgedon

Situate on the west side of French Creek in Allegheny County
 containing 401 Acres 150 perches and allowance of six pr Cent for Roads
 & Surveyed the 1st Mar^{ch} 1800 In pursuance of a Warrant granted to
 Richard McClure dated the 4th day of January 1794

John Power D^r Sr.

To Daniel Brodhead Esquire

Surveyor General

IN TESTIMONY that the above is a copy of the original remaining on file in
 the Department of Internal Affairs of Pennsylvania, made
 conformably to an Act of Assembly approved the 16th day of
 February, 1833, I have hereunto set my Hand and caused
 the Seal of said Department to be affixed at Harrisburg,
 this fifth day of March 1906

Isaac N. Brown
 Secretary of Internal Affairs.